

| QUAN | STOCK # | DESCRIPTION                                 | QUAN | STOCK # | DESCRIPTION                             | QUAN | STOCK # | DESCRIPTION | SPECIFICATIONS & CONSTRUCTION INFORMATION |
|------|---------|---|------|---------|---|------|---------|-------------|---|
|      |         | MODEL LVDW-1500-7                           |      |         | DOUBLE WALL DERROUND STEEL STORAGE TANK |      |         |             |   |
|      |         | DESCRIPTION: HAZARDOUS WASTE TANK, 10 GAUGE |      |         |   |      |         |             |   |
|      |         | OPENINGS: MINIMUM 3-2" FNPT FLANGE          |      |         |   |      |         |             |   |
|      |         | 1-6" FNPT FLANGE                            |      |         |   |      |         |             |   |
|      |         | 1-6" FNPT ELBOW w/PLUG                      |      |         |   |      |         |             |   |
|      |         | 1-3/4" FLANGE                               |      |         |   |      |         |             |   |
|      |         | CONSTRUCTION: WELDED USING 3/16" ERW        |      |         |   |      |         |             |   |
|      |         | FINISH: ENAMEL COAT IS OPTIONAL             |      |         |   |      |         |             |   |
|      |         | FINISH: RED PRIMER                          |      |         |   |      |         |             |   |
|      |         | NOTE: FINISH ENAMEL COAT IS OPTIONAL        |      |         |   |      |         |             |   |

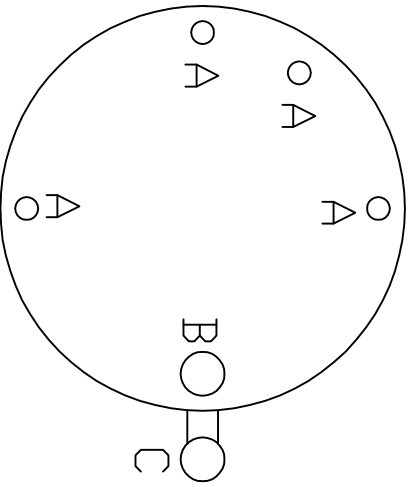
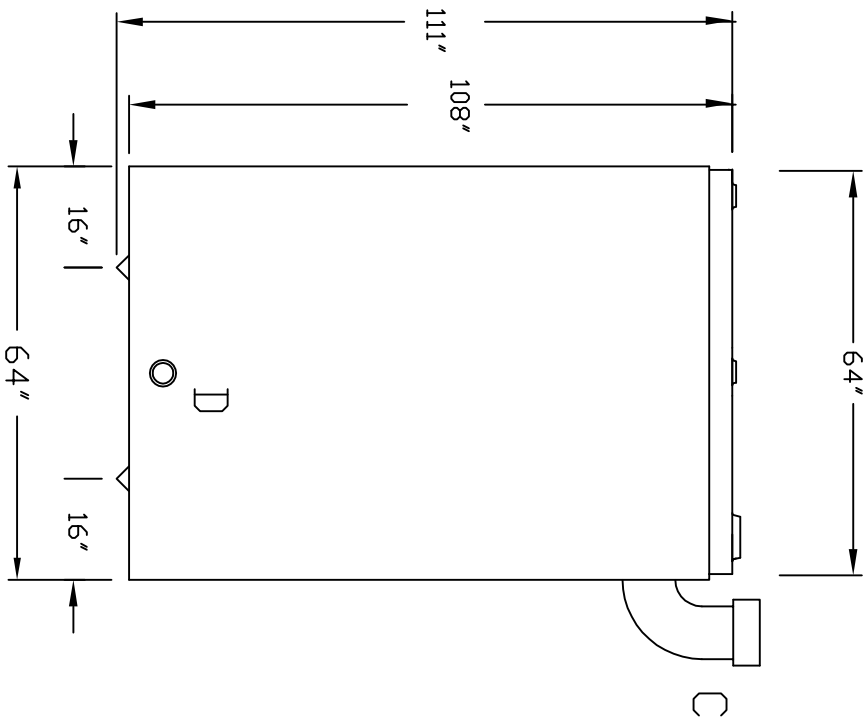

- LEGEND
- A - OPENINGS FOR FILL GAUGE, AND NORMAL VENT: 2" FNPT FLANGE
  - B - OPENINGS FOR INNER TANK EMERGENCY VENT: 6" FNPT FLANGE
  - C - OPENING FOR OUTER TANK EMERGENCY VENT: 6" FNPT PIPE ELBOW WITH PLUG
  - D - 3/4" INSPECTION FLANGE FOR INTERSTICE WITH STEEL PLUG

DWG #: LVDW-1500-7      SCALE: NONE      DATE: 12-28-06      REVISION:      APPROVED:      APPROVAL DATE: